



# GRANGE CITY HOTEL

8-14 Cooper's Row, London EC3N 2BD

Tel: 020 7863 3700 Fax: 020 7863 3701

Email: [city@grangehotels.com](mailto:city@grangehotels.com)



With spectacular views over the Tower of London and the river Thames and with a range of luxury facilities and amenities, the Grange City Hotel is within easy walking distance of London's major financial institutions and minutes from the West End and Docklands.

The conference and events centre offers some of the finest facilities in the City with a unique Auditorium and seven additional flexible suites all featuring state-of-the-art equipment and flooded with natural daylight. The Grange City Hotel ensures a memorable experience... for all the right reasons.



ROOM TYPES	FLOOR	DIMENSIONS (m)			CAPACITIES								NATURAL DAYLIGHT	AIR-CON
		L	W	H	T/S	B/R	C/R	U-S	CAB	L/D	D/D	REC		
Auditorium	1	15.2	22.8	5.2	500	120	260	160	168		300	600	Yes	Yes
Lion	1	15.2	10.4	5.2	195	60	110	80	96		120	300	Yes	Yes
Bell	1	15.2	10.4	5.2	195	60	110	80	96		120	300	Yes	Yes
Beauchamp	1	7.7	13.9	2.4	100	40	60	36	64		90	100	Yes	Yes
Flint	1	7.7	7	2.4	50	20	20	18	18		40	50	Yes	Yes
Bowyer	1	7.7	6.7	2.4	50	20	20	18	18		40	50	Yes	Yes
Crown Suite	1	16.9	5.4	2.4	120	40	60	38	64		60	100	Yes	Yes
Wakefield	1	16.9	5.4	2.4	40	40	30	30	48		60	100	No	Yes
Devereux	1	5.4	3.1	2.4	20	6	15	10	15		30	40	No	Yes
Martin	1	5.4	4.8	2.4	20	6	15	10	15		30	40	No	Yes
Constable	1	5.4	4.6	2.4	20	6	15	10	15		30	40	No	Yes
Develin	1	5.4	3.7	2.4	20	6	15	10	15		30	40	No	Yes
Syn: 613-513		12	3.5	2.4	40	20	-	18	18		-	35	Yes	Yes
Forum		20	13	5	-	-	-	15	-		180	250	No	Yes
Presidential Suite	12				40	20	12		15		30	75	Yes	Yes

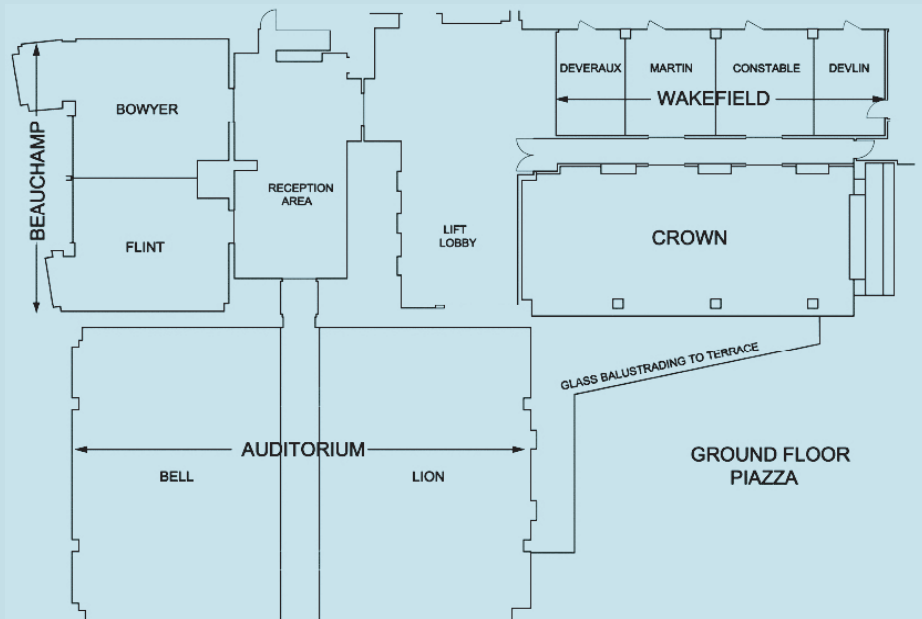

- VIDEO CONFERENCING
- WIRELESS INTERNET
- BUSINESS CENTRE